

Rev.	Description	Date
A0	New release	2023.12.29

1. PHYSICAL CHARACTERISTICS (mm)

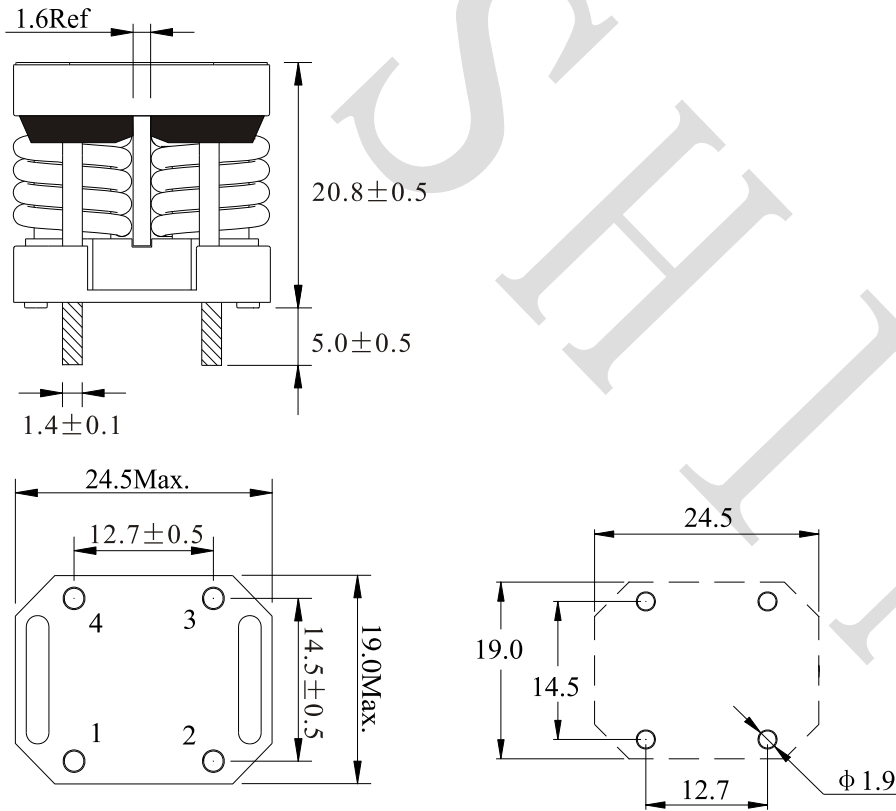

2. ELECTRONICAL SCHEMATIC

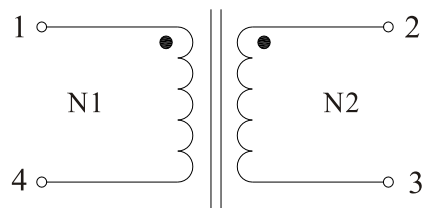

3. ELECTRONICAL SPECIFICATIONS @25°C

Inductance: 120uH Min@100KHz,0.1V

IDC: 22.0A Max

RDC: 2.4mΩ Max

Operating temperature: -40°C to +125°C

(Including self-temp. rise)

Storage temperature: -40°C to +125°C

Test Instrument:

L: HP4284A

RDC: HM2540

Note:

1. Solderability: leads shall meet MIL-STD-202,

Method 208D for solderability.

2. Flammability: UL94V-0

3. ASTM oxygen index: >28%

NAME:	Common mode choke		
CUSTOMER P/N:		DATE:	2023-12-29
SHINHOM P/N:	SQ2420-121Y-22A	REV: A0	PAGE
DRAWN BY	CHECKED BY	APPROVE BY	



SHINHOM

SHANHOM SHAANXISHINHOM ENTERPRISE CO LTD

The Document property belong to SHINHOM & is not allowed to be duplicated without authorization

Impedance vs Frequency

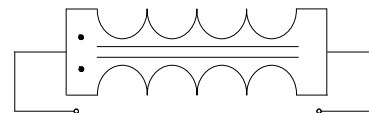
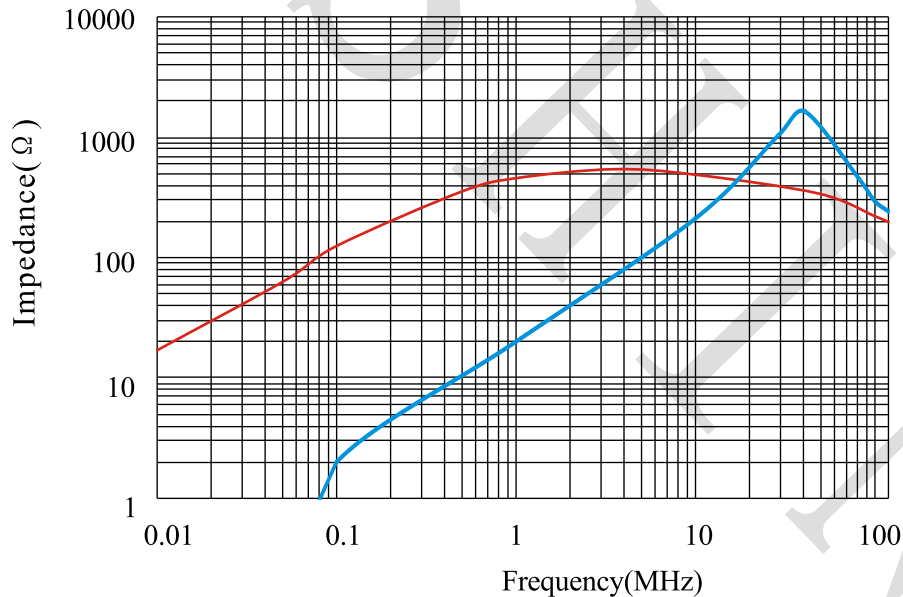

Common Mode

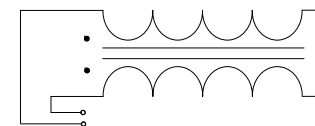

Differential Mode

Common mode: —

Differential mode: —

NAME:	Common mode choke		
CUSTOMER P/N:		DATE:	2023-12-29
SHINHOM P/N:	SQ2420-121Y-22A	REV: A0	PAGE
DRAWN BY	CHECKED BY	APPROVE BY	



SHINHOM

SHAANXISHINHOM ENTERPRISE CO LTD

The Document property belong to SHINHOM & is not allowed to be duplicated without authorization